

Georgia World Congress Center Authority

June 18, 2013

Board of Governors Meeting



Finance





Financial Snapshot



Profit/Loss



Projected May	\$101,076	\$397,782	\$53,419
Actual May	20,078	638,190	53,642
Projected YTD	947,183	16,963,006	83,242
Actual YTD	1,115,218	23,739,105	458,364



H/M Tax

Year-to-date

Actual **\$21.50M**

Budget **\$20.19M** **6.48%**

FY12 **\$19.36M** **11.05%**



Customers

(Estimated)

143,520



Economic Impact

59.3M

(Estimated)





NSP Conceptual Design

Bill Johnson
360 Architecture



EXTEND INTERNATIONAL
DECK.

GWCC

CONCEPT DESIGN REVIEW

JUNE 2013





GOODE VAN SLYKE

- 17+ YEARS OF EXPERIENCE IN THE PUBLIC AND PRIVATE SECTORS
- PROVEN TRACK RECORD MANAGING PROJECTS IN URBAN NEIGHBORHOODS
- DEEP PROJECT HISTORY IN THE VINE CITY NEIGHBORHOOD



STANLEY BEAMAN & SEARS

FULTON COUNTY/ATLANTA BASED COMPANY FOR 20 YEARS

HISTORY OF SUCCESSFUL COLLABORATIONS WITH WORLD-CLASS ARCHITECTURAL FIRMS

AWARD WINNING ARCHITECTURE AND INTERIORS + INNOVATIVE ENVIRONMENTAL AND ENTERTAINMENT GRAPHICS



tvstdesign

INNOVATIVE, ESTABLISHED DESIGN LEADER IN ATLANTA AND WORLDWIDE

DESIGNED THE ORIGINAL AND SUBSEQUENT EXPANSION FOR THE GWCC

FIRSTHAND KNOWLEDGE OF GWCC CAMPUS



PERMISSION TO CHALLENGE EVERYTHING

ACT RESPONSIBLY

EXPERTS OUTSIDE THE INDUSTRY

EMBRACE CHANGE

RE-IMAGINE THE GAME DAY EXPERIENCE

REJECT CURRENT THINKING

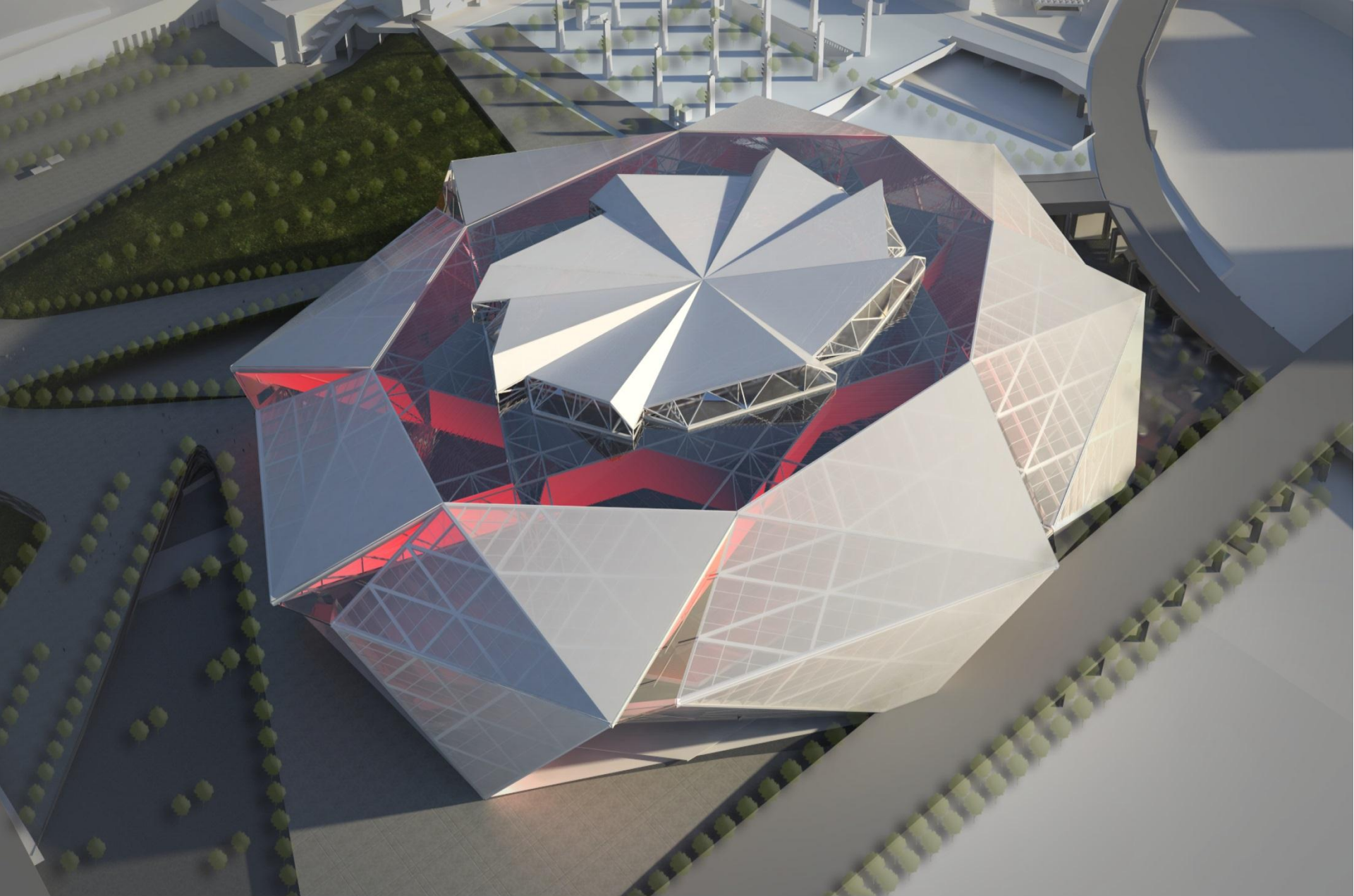

OCULUS CLOSED

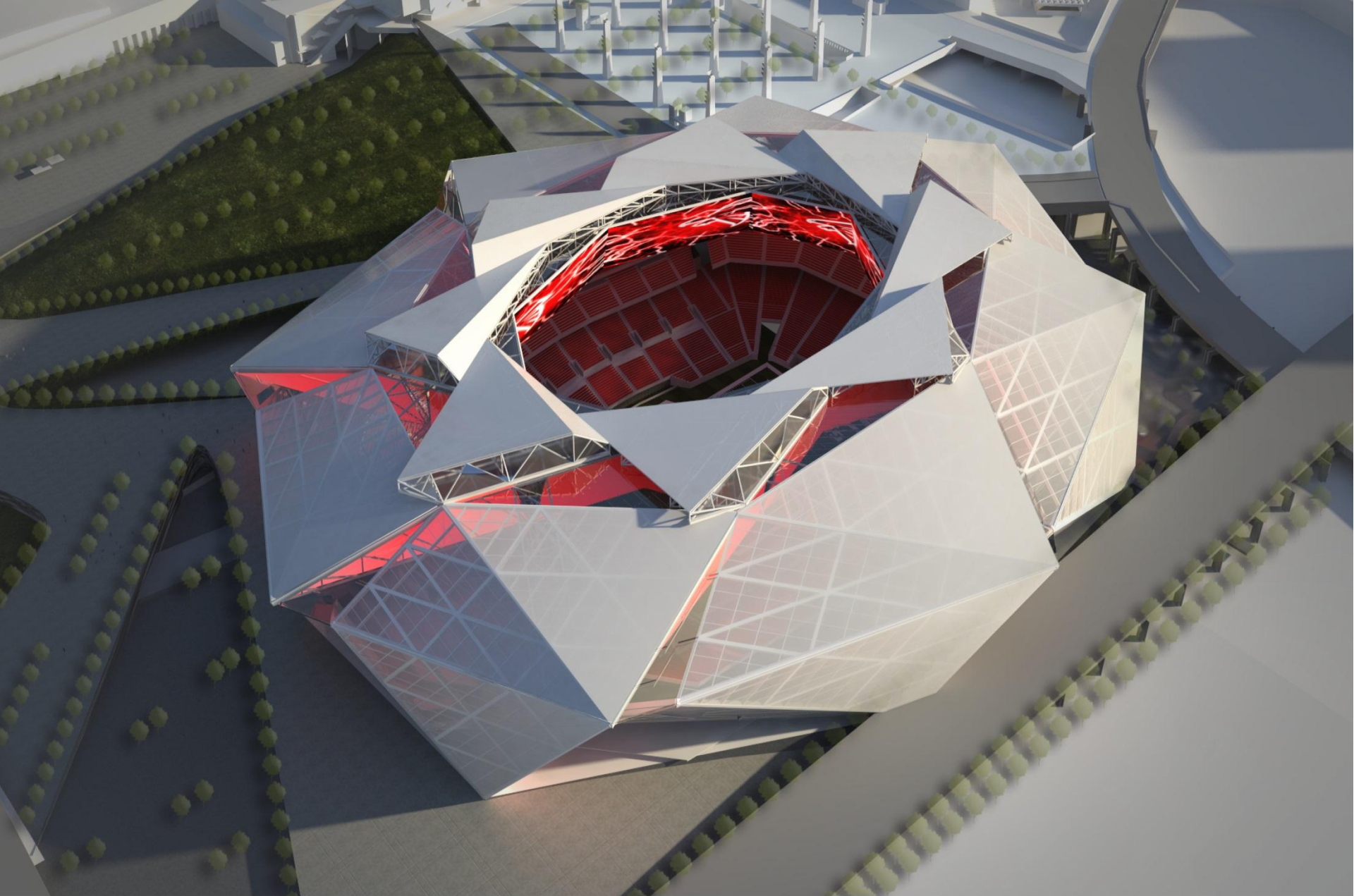

OCULUS IN OPEN POSITION

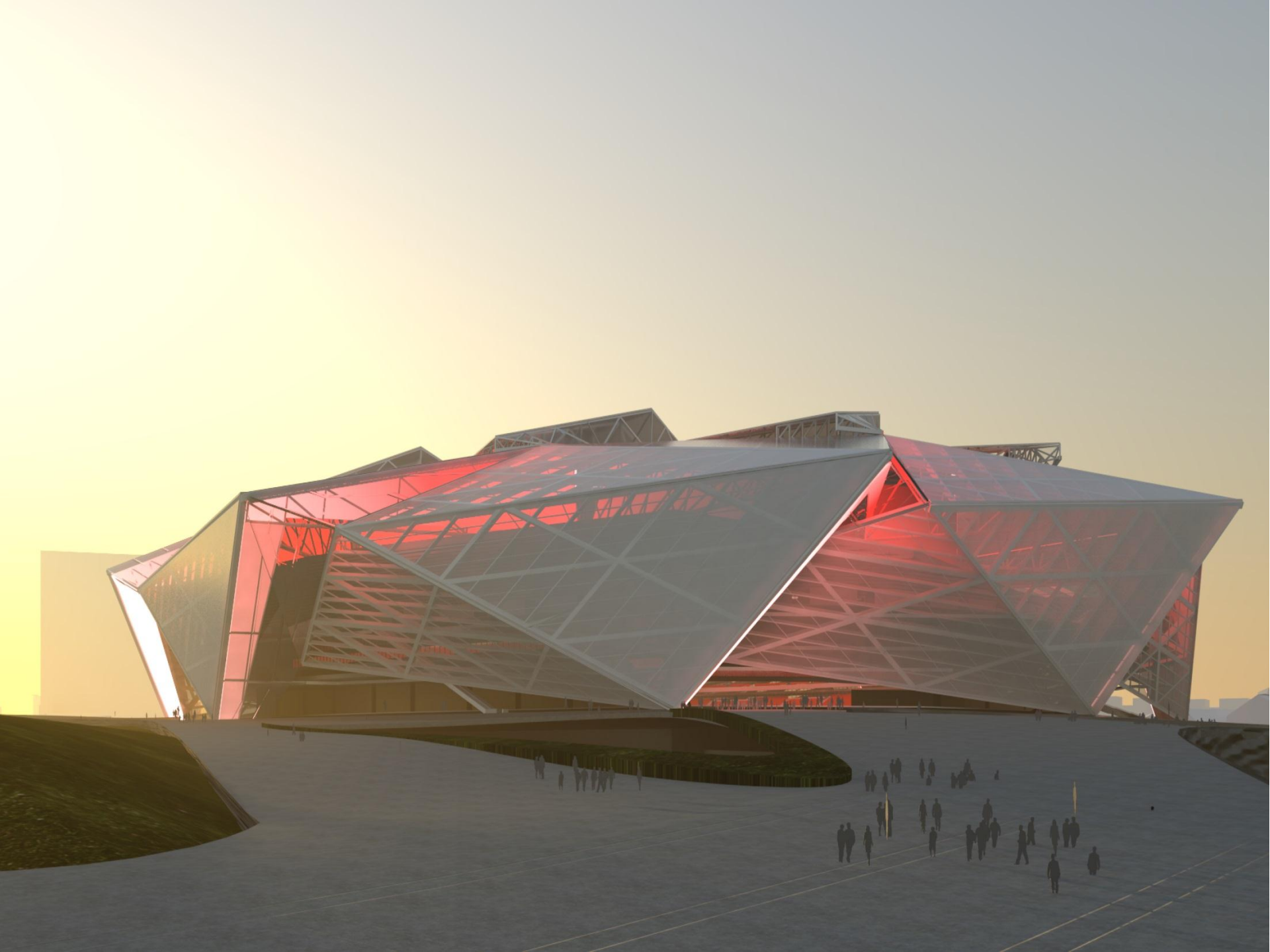

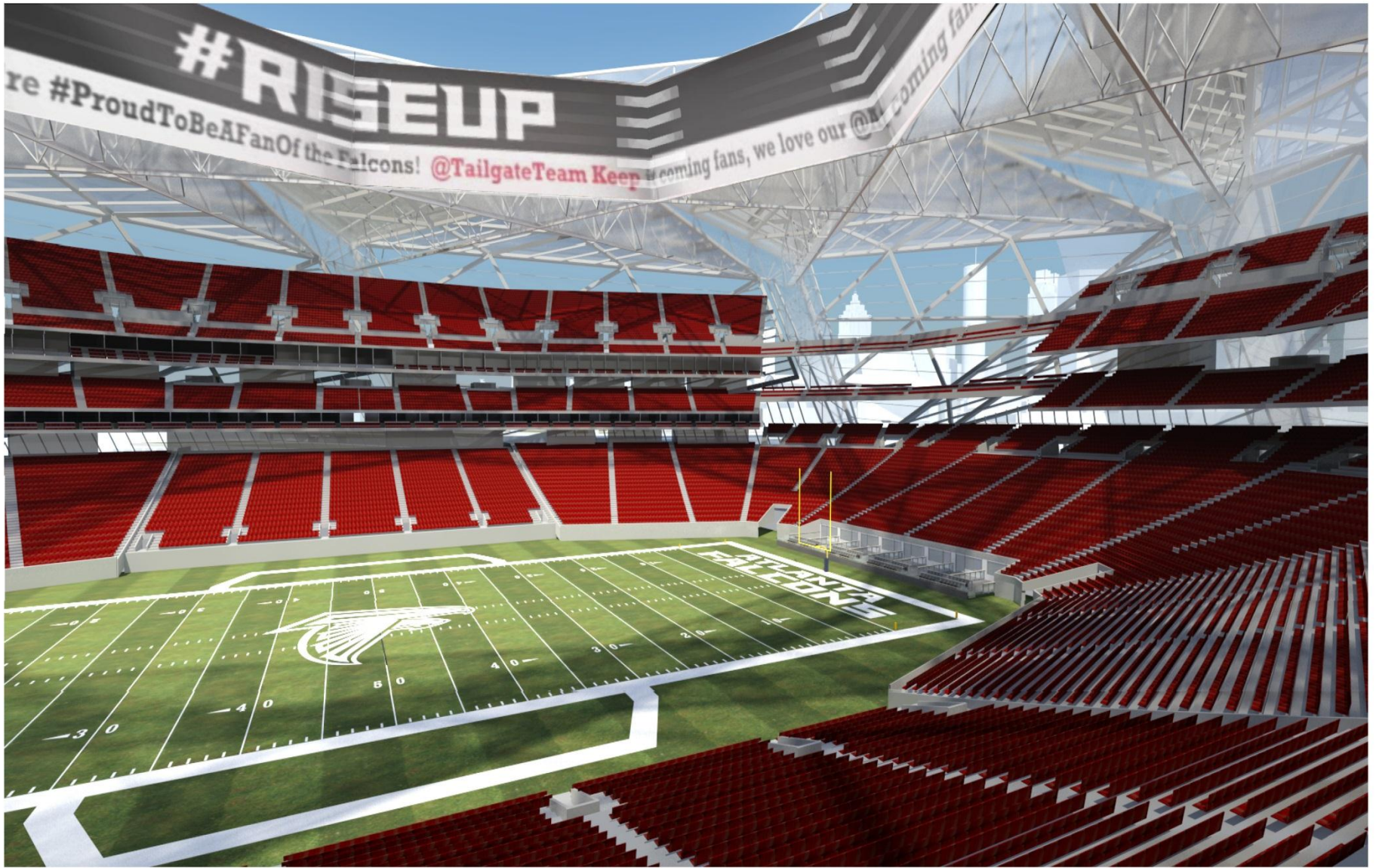

WINDOW TO THE CITY
CLUB VIEW

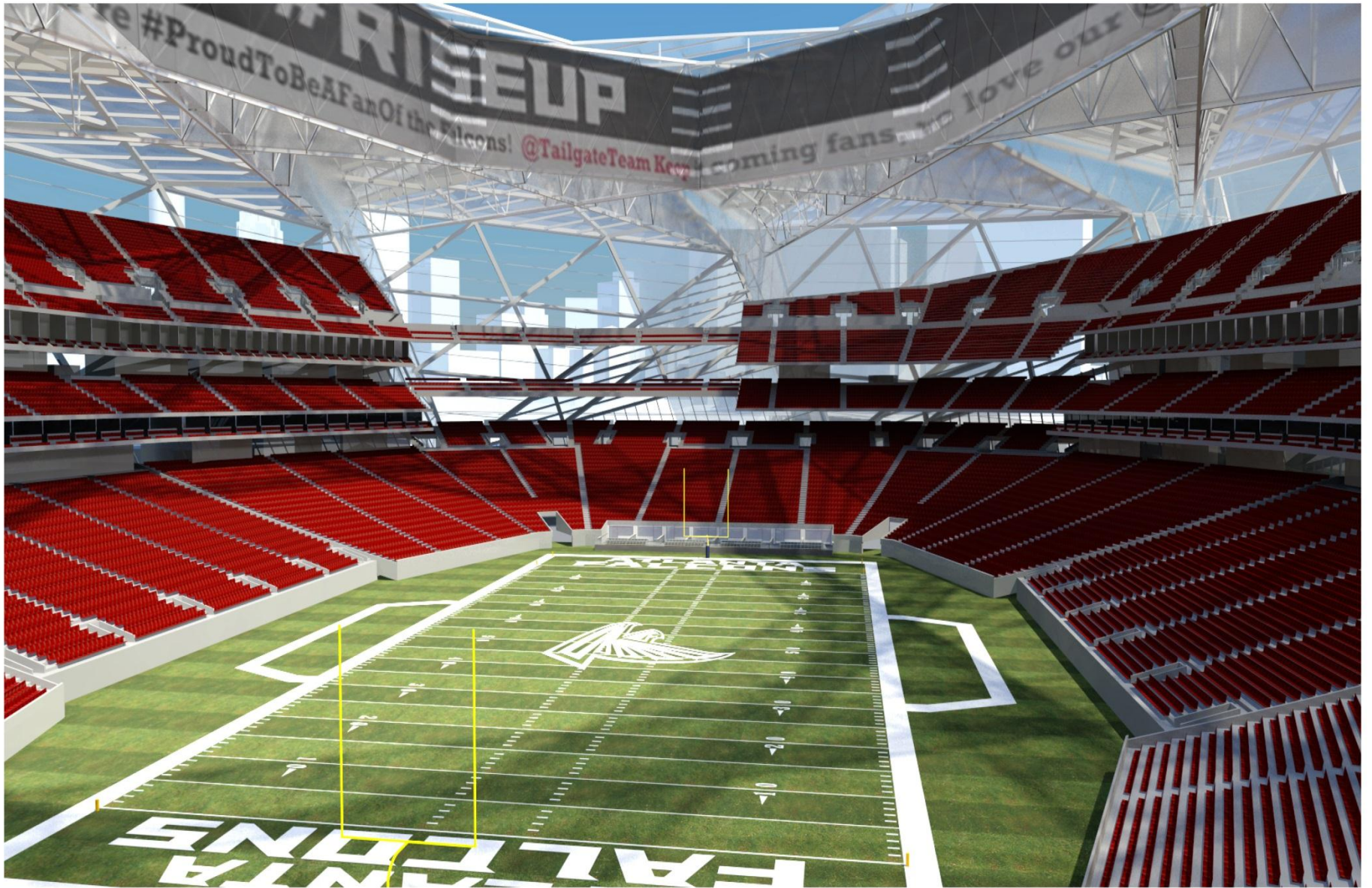

LOWER BOWL END ZONE
INTERIOR VIEW



SUNTRUST
PLAZA

MARRIOTT
MARQUIS

WESTIN

191 PEACHTREE
TOWER

ATLANTA
CENTENNIAL

OLYMPIC
FOUNTAIN

PHILLIPS
ARENA

OMNI
HOTEL

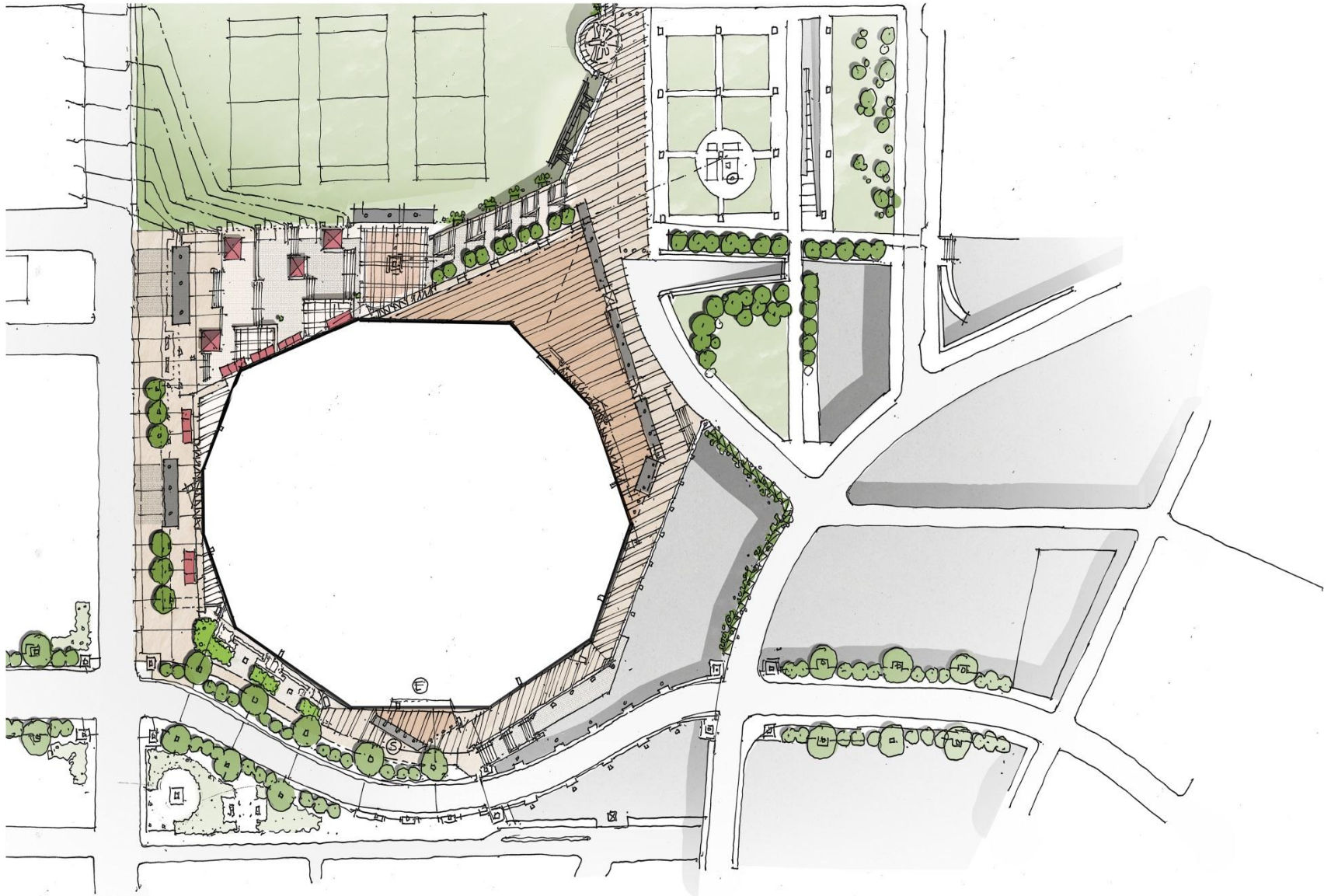

SITE DIAGRAM

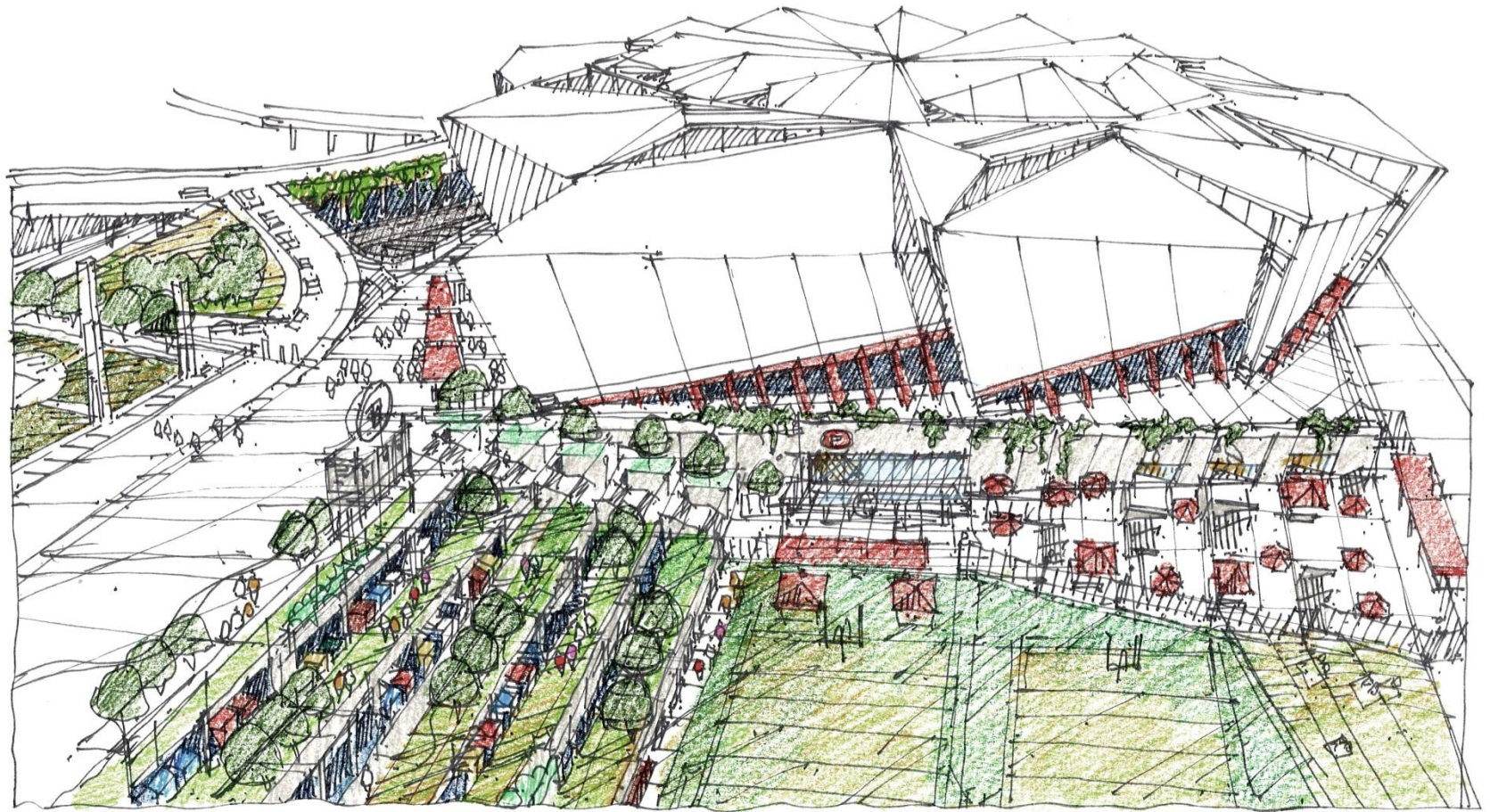

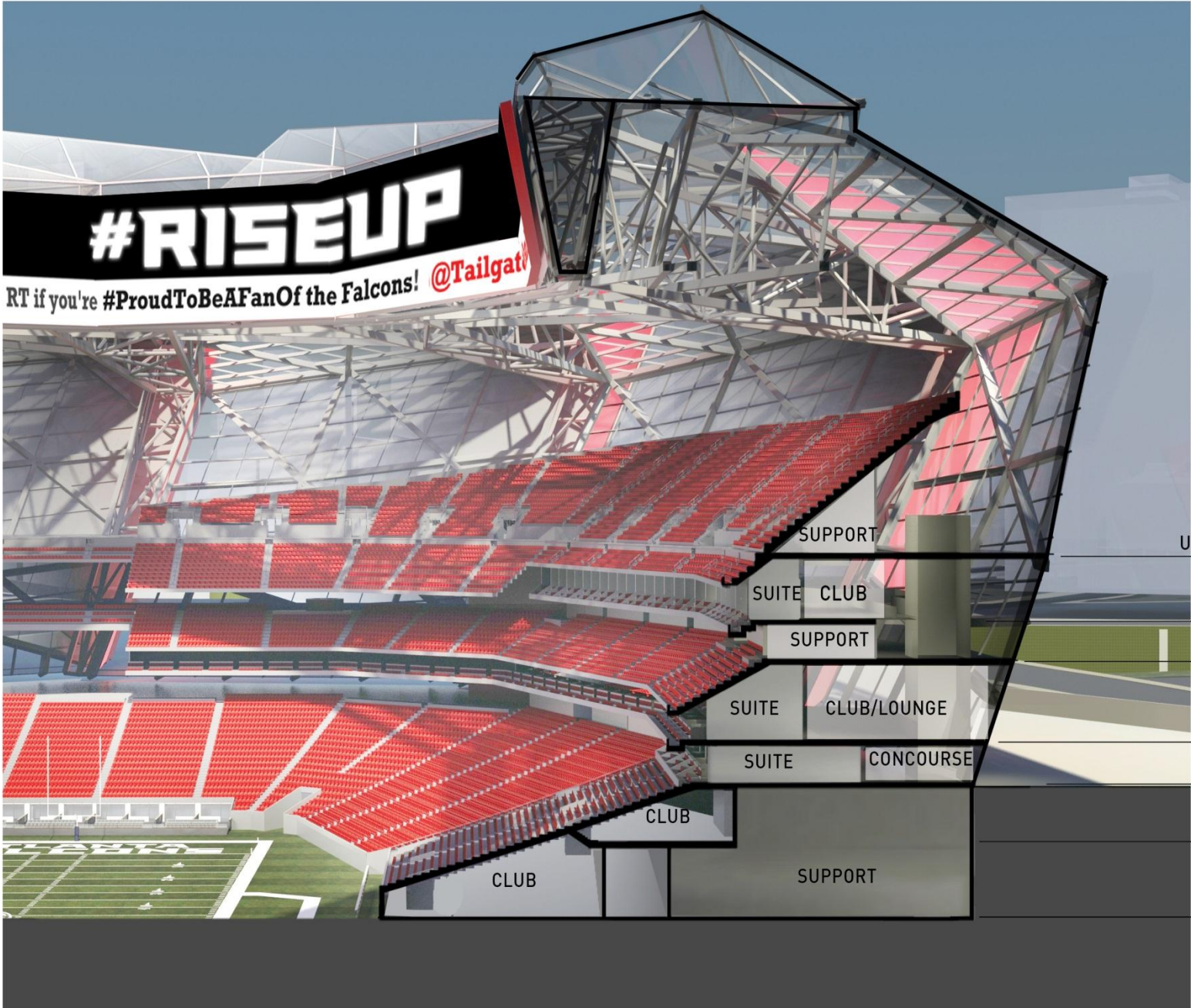

#RISEUP

RT if you're #ProudToBeAFanOf the Falcons! @Tailgate

- UPPER CONCOURSE
+1122'-8"
- UPPER SUITE
+1102'-9"
- CONCOURSE 2
+1090'-1"
- LOW SUITE
+1065'-4"
- CONCOURSE 1
+1052'-8"
- CLUB MEZZ
+1032'-0"
- FIELD LEVEL
+1010'-0"

SUPPORT

SUITE CLUB

SUPPORT

SUITE CLUB/LOUNGE

SUITE CONCOURSE

CLUB

CLUB

SUPPORT

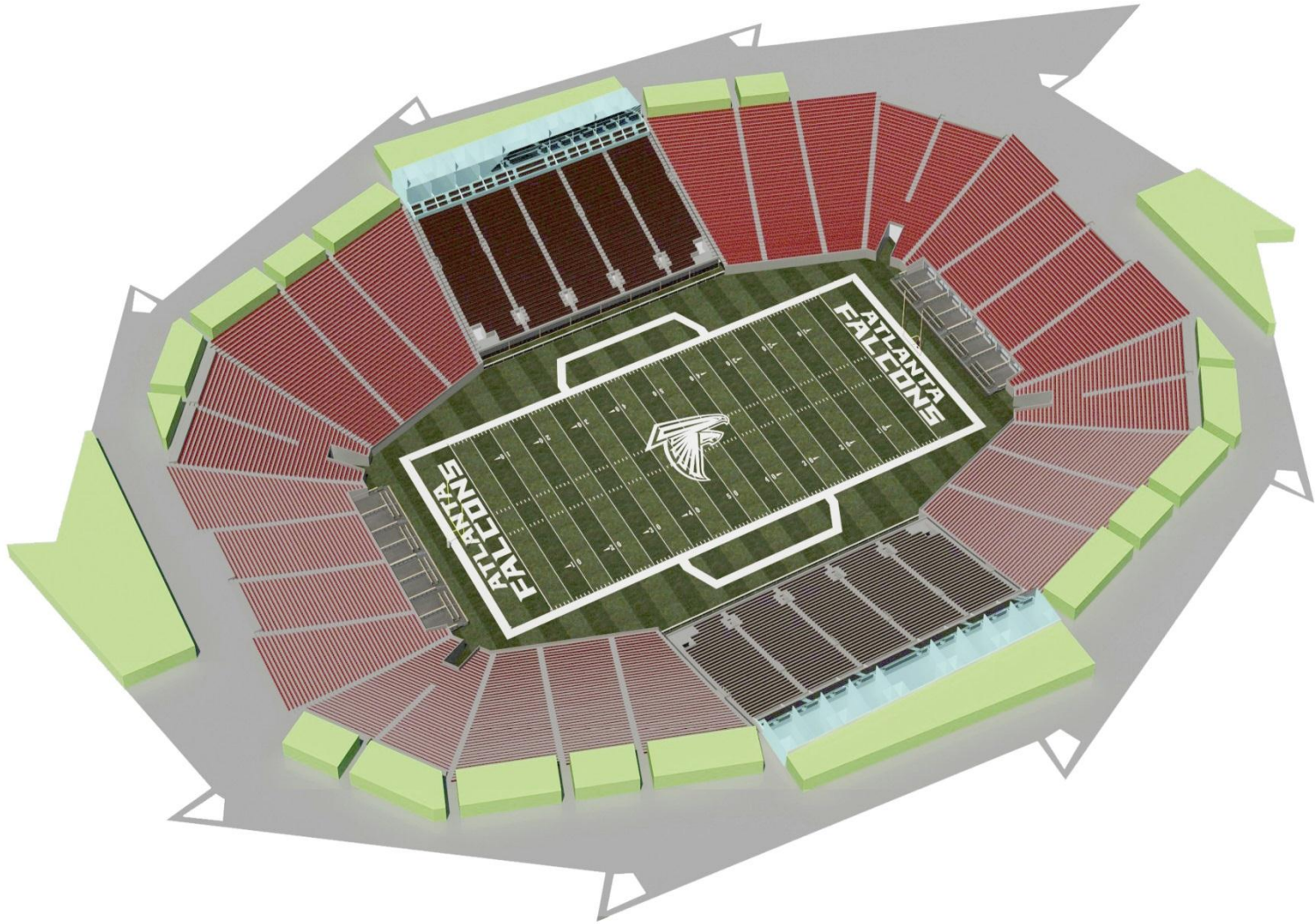

PLAN AXON
CONCOURSE 01

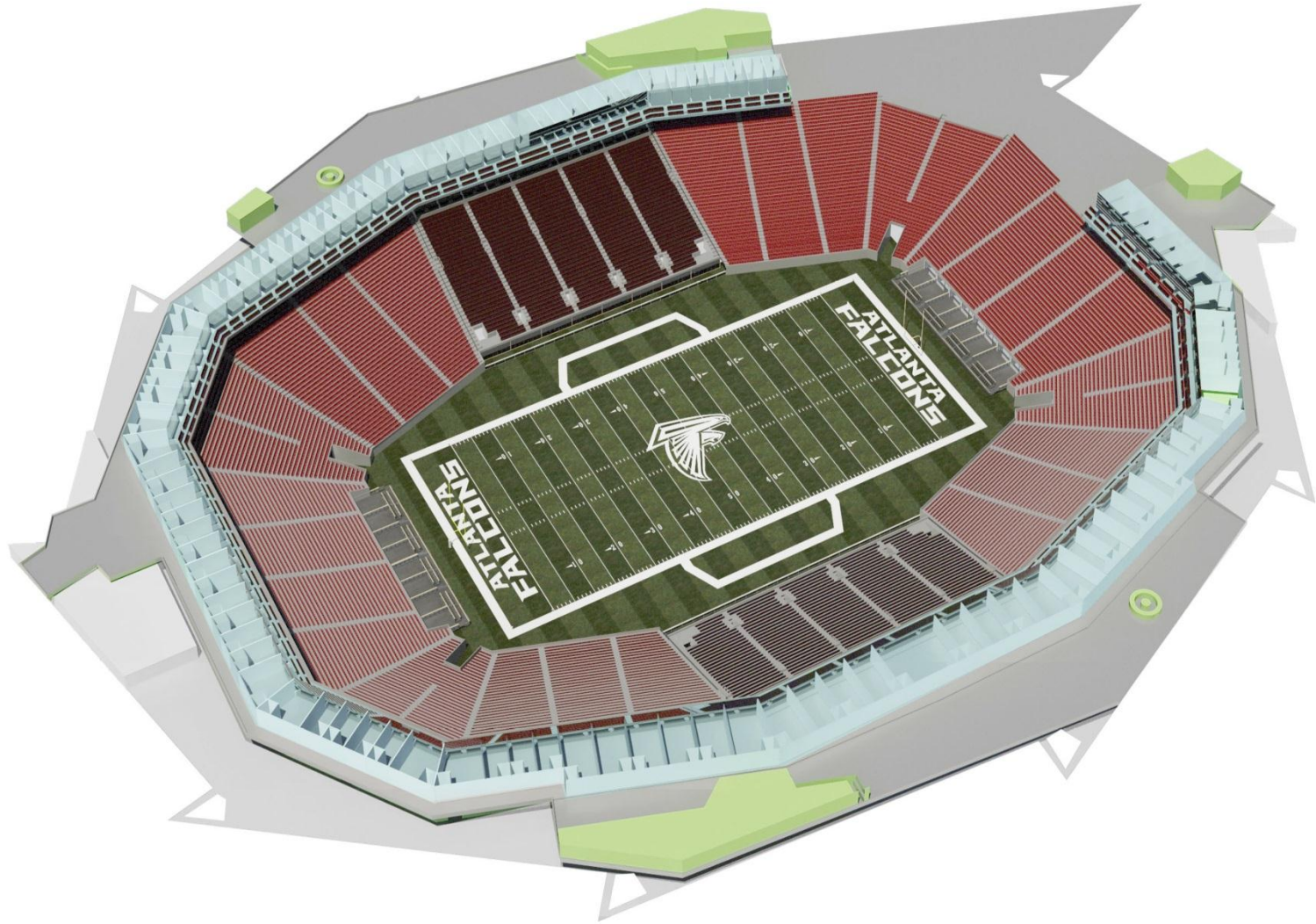

LOWER SUITE



CONCOURSE 02



UPPER SUITE

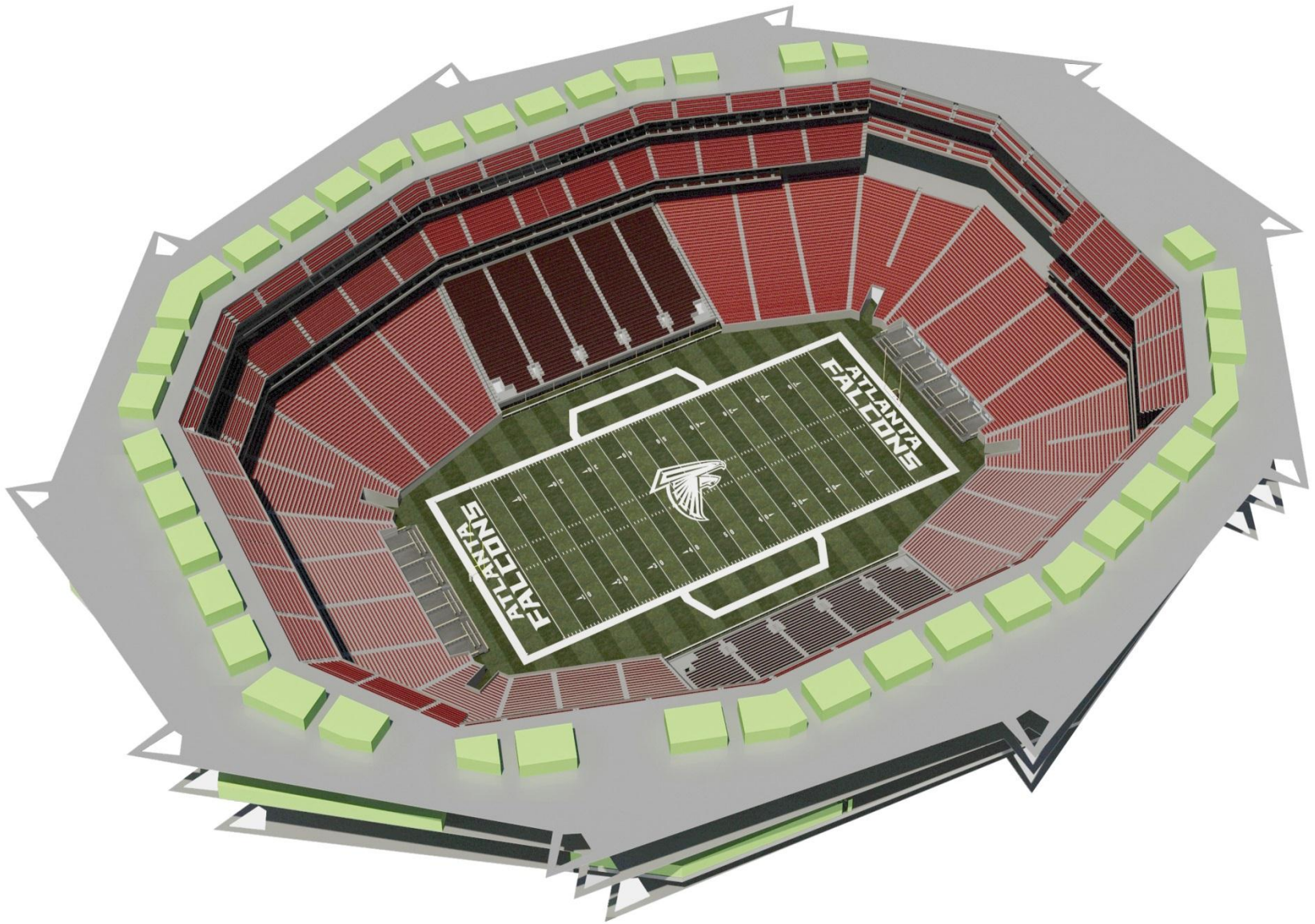

CONCOURSE 03



SEATING BOWL



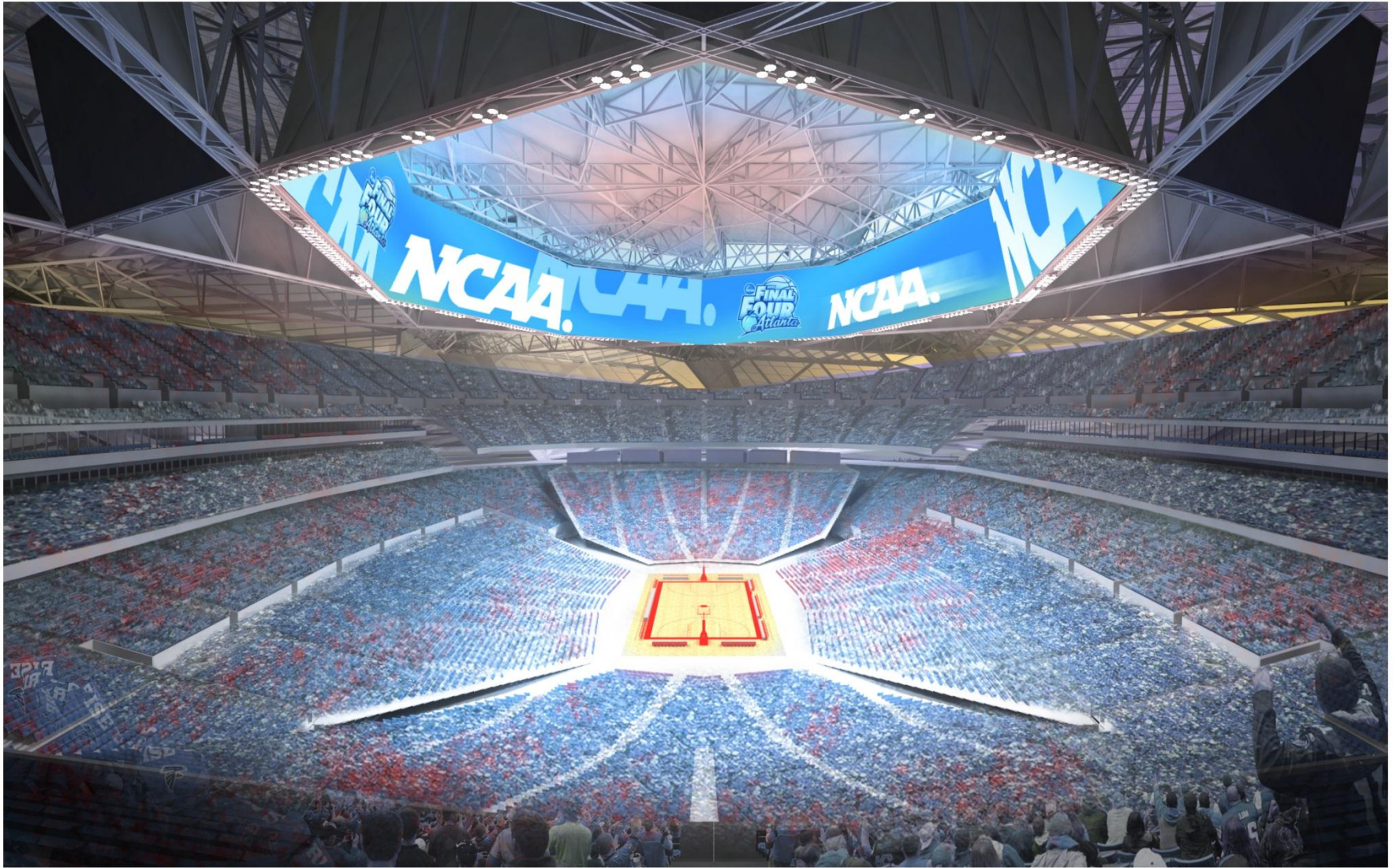





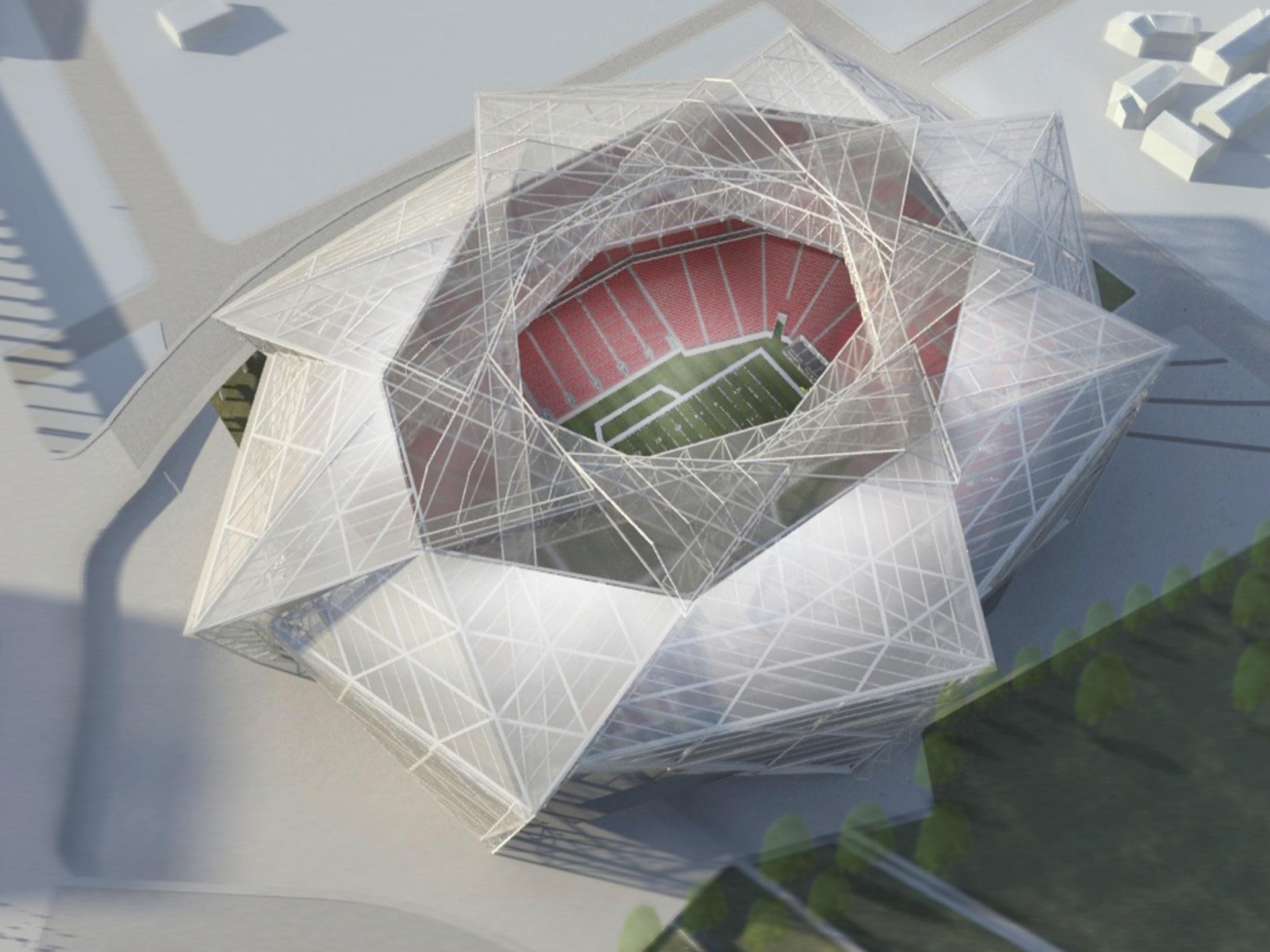

EXTEND INTERNATIONAL
DECK.

THREESIXTY ARCHITECTURE

KANSAS CITY

COLUMBUS

SAN FRANCISCO



300 W. 22ND STREET
KANSAS CITY MO 64108

816.472.2100
360ARCHITECTS.COM



Questions?





MOU

Pursuant to Section 3.3 of Article III and Exhibit F of the MOU, the Authority will have final approval rights **at the conceptual**, schematic and design development stages over the drawings, plans, and specifications for the overall Material Design Elements for the NSP which are those design elements that (i) **materially affect the exterior appearance of the NSP...**





Staff Recommendation

Approval of 360 Architecture's conceptual design which materially affects the exterior appearance of the NSP.





NSP General Contractor / Construction Manager

Charlie Thornton
ICON Venue Group



CM / GC Selection

Request for Qualifications

1. Industry-Wide Outreach
 - a. Dodge Report
 - b. Targeted Industry Contacts
2. Asked for Firms to Submit Independently
3. Provided for Broadest Possible Opportunity for Diversity
4. Received Qualification Statements from Nine (9) Highly Skilled and Experienced Firms Plus Two (2) Firms Interested but not as Lead CM / GC
5. Interviewed All Nine (9) Proposing Firms
6. Shortlisted Five (5) Most Qualified Firms



CM / GC Selection

Request for Proposals

1. Firms Were Allowed to Assemble Teams from the Nine (9) Qualified Firms and the Two (2) Additional Firms not Interested in Lead CM / GC Role
2. Proposal Review Resulted in Three (3) Finalists
 - a. Holder/Hunt Joint Venture
 - b. Skanska
 - c. Turner Construction Company
3. Selection Criteria Established
 - a. Overall Costs to Deliver Project
 - b. Team and Individual Experience and Depth
 - c. Project Portfolio
 - d. Culture and Chemistry
4. Final Interviews and Detailed Negotiations with Each Finalist
5. Holder/Hunt Joint Venture was Ranked #1 Based on Criteria

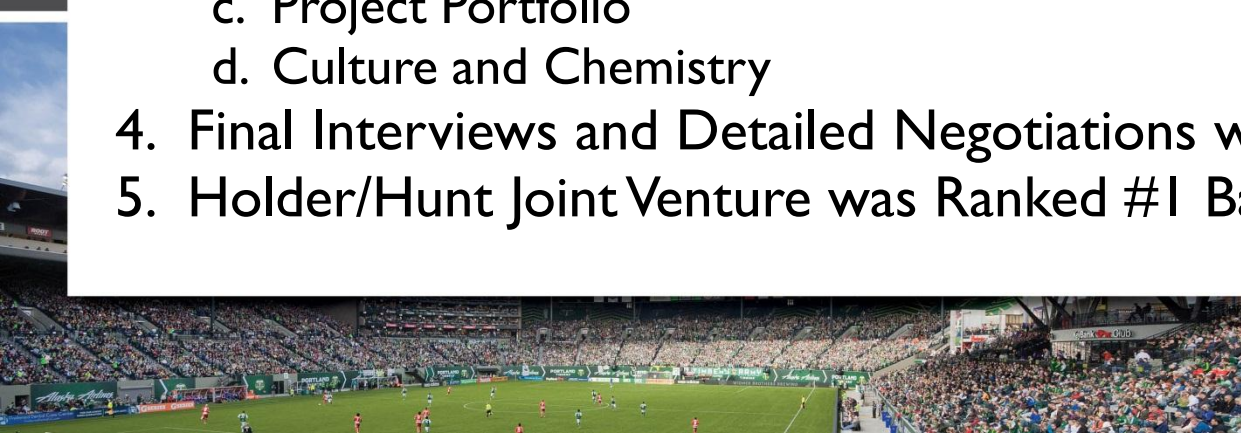



EXECUTIVE SUPPORT

TOMMY HOLDER

35 YEARS



PRINCIPAL IN CHARGE

WAYNE WADSWORTH

23 YEARS 102 LOCAL PROJECTS



EXECUTIVE SUPPORT

KEN JOHNSON

28 YEARS 17 SPORTS PROJECTS



PROJECT EXECUTIVE

RANDY RAGER

33 YEARS 28 LOCAL PROJECTS



EXECUTIVE SUPPORT

ROBERT MAY

37 YEARS 9 SPORTS PROJECTS



PROJECT DIRECTOR

SCOTT BLANCHARD

26 YEARS 15 SPORTS PROJECTS



GENERAL SUPERINTENDENT

BOB EVANS

39 YEARS 28 LOCAL PROJECTS



Preconstruction

Construction

PRE-CONSTRUCTION DIRECTOR

MIKE BURNETT

17 YEARS 20 LOCAL PROJECTS



SENIOR PROJECT MANAGER

PAT DELANO

28 YEARS 8 SPORTS PROJECTS



SENIOR PROJECT MANAGER

PETE PEMANTELL

16 YEARS 7 LOCAL PROJECTS



DIRECTOR - INTERIOR CONSTRUCTION

GREER GALLAGHER

13 YEARS 35 LOCAL PROJECTS



EBO

MEP / Commissioning

Sustainability

Special Systems / Technology

EBO MANAGER

BILL EDWARDS

20 YEARS 24 SPORTS PROJECTS



MEP SERVICES DIRECTOR

SAM WESTBROOK

13 YEARS 23 LOCAL PROJECTS



SUSTAINABLE SERVICES SR MANAGER

AMANDA ATKINSON

12 YEARS 16 LOCAL PROJECTS



MANAGER - SPECIAL SYSTEMS

DOMINIC MIRANDA

34 YEARS 8 SPORTS PROJECTS





Questions?





MOU

Pursuant to Section 3.7 of Article III of the MOU, the parties agreed that StadCo will select the General Contractor(s) for the NSP and will make its recommendation to the Authority. The Authority will have final approval rights over the General Contractor(s) engaged for construction of the NSP and the terms of the Construction Contract .





Staff Recommendation

Approval of the recommended General Contractor(s) and construction contract terms for the NSP.

